

CARATTERISTICHE

Luce nominale
 Portata max
 Pressione di lavoro max
 Temperatura ambiente
 Temperatura olio
 Filtraggio consigliato
 Peso

Vedi pag. successiva / See next page
Vedi pag. successiva / See next page
250 / 350
-30°C + 50°C
-30°C + 80°C
30+60
Vedi pag. successiva / See next page

PERFORMANCE

Rated size
 Max flow-rate
 Max working pressure
 Room temperature
 Oil temperature
 Recommended filtration
 Weight

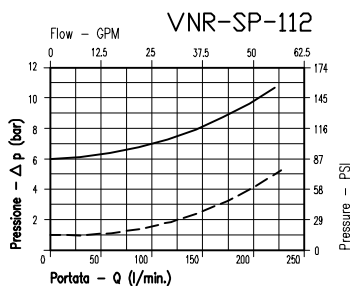
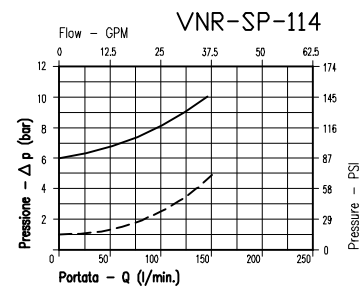
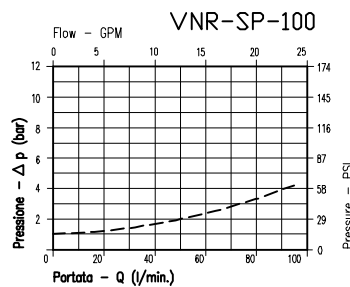
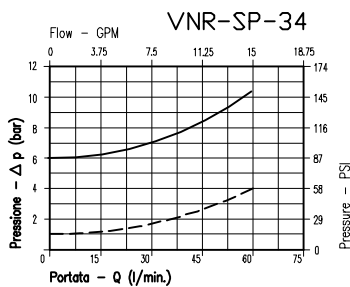
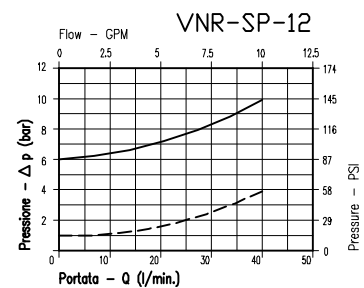
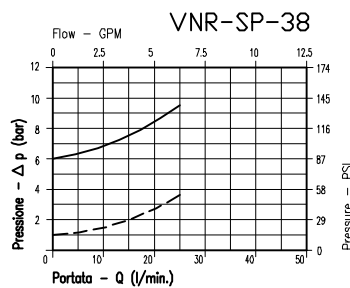
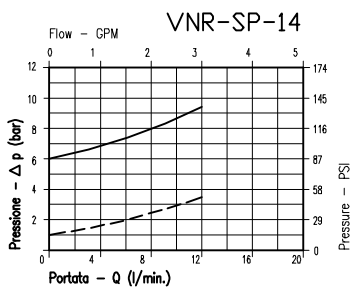

———— VNR/SP-... 6÷8 Bar
 - - - - - VNR/SP-... 1 Bar

Viscosità olio 46 cSt a 50°C
Oil viscosity 46 cSt at 50°C

VALVOLA DI BLOCCO CON TENUTA A SPILLO
CHECK VALVE, POPPET TYPE

(1/4" - 3/8" - 3/4" - 1")

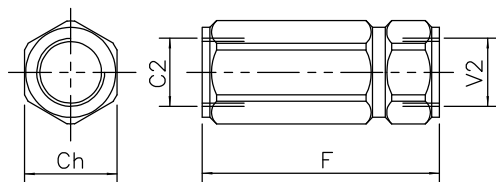

(1/2" - 1"1/4)

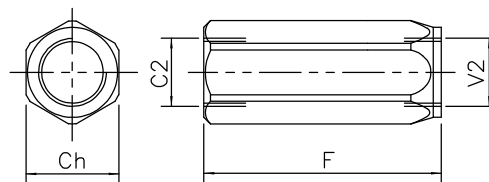

(1"1/2)

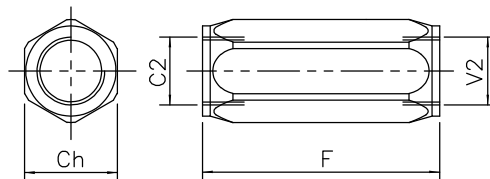

DIMENSIONI
DIMENSIONS

NUMERO VALVOLA VALVE NUMBER	CH	F	Attacchi Port size V2-C2 GAS (BSPP)	Luce nominale rated size DN	Portata max Max flow-rate	Peso Weight kg
					l/min	
016	19	57	1/4"	6	20	0,10
017	24	61	3/8"	8	40	0,16
018	27	75	1/2"	11	60	0,31
019	36	92	3/4"	16	60	0,50
020	41	110	1"	20	120	0,75
001	55	135	1"1/4	25	160	1,75
002	60	135	1"1/2	30	250	1,90

CODICE DI ORDINAZIONE
HOW TO ORDER

003	016	0	J	0
	Numero valvola / Valve number		Inizio apertura Cracking pressure	
	016		J	1 bar Molla (colore nero) Spring (black)
	017			
	018			
	019			
	020			
	001			
	002		W	6-8 bar Molla (colore giallo) Spring (yellow)